

MXEvo - dia 6 mm - Captive pin - Max rope size 8 mm

Part #11603

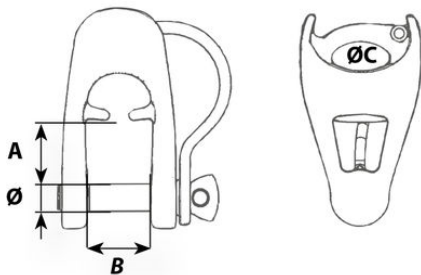

Description

MXEvo is the new generation of one-piece blocks developed by Wichard.

Thanks to the leash, this MXEvo version can't lose its pin while opening, manipulating and closing the block. The pin is forged in high-resistant 17.4PH stainless steel.

Main MXEvo features:

- > Dedicated to heavy load applications
- > Impressive working and breaking load limits
- > Captive pin on the standard version
- > Becket function to make tackles
- > Rope kept on track thanks to the fins
- > Optimized weight and dimensions
- > Easy opening - Easy rope installation
- > Two versions existing in three sizes
- > Limited rope wear thanks to the track conception
- > Monobloc item (without mechanical part) for a better reliability
- > For max rope size 8 mm

Applications

- > 2:1 halyard purchase: mainsail, spinnaker, gennaker
- > Flying sail furler terminals: tensioning at the top or from the bottom

Technical information

Materials	316L stainless steel grade
Rope size	Pour cordage de 8 mm
Length (mm)	53
Width (mm)	26
 Working load (kg)	1040
Breaking load (kg)	2300
Weight (g)	53
A (mm)	18
B (mm)	13
C (mm)	7
D diameter (mm)	6

Wichard strives to ensure, to the best of its ability, the accuracy and the update of the information disseminated on this document, and reserves the right to correct at any time and without notice the content, as well as to evolve its products.

In the case of an industrial application, please contact our sales and technical department to validate the use of these products. The request for certificates can be made directly with the sales department when ordering the products.

Non-contractual pictures.

Caption



Working load (WL) : for nautical applications



Working Load Limit (WLL): for industrial applications only.

The safety factor is 5 times the breaking load.

WLL = Breaking load / 5